



**SCOTT 2011
BIKE OWNERS
MANUAL**

SCOTT SPORTS SA | 17 RTE DU CROCHET | 1762 GIVISIEZ | SWITZERLAND
© 2009 SCOTT SPORTS SA, ALL RIGHTS RESERVED | SCOTT-SPORTS.COM





CONTENT

Congratulations	P. 004
General introduction	P. 005
Safety	P. 005
Assembly of training wheels	P. 006
Chain tension	P. 006
Brakes	P. 007
Light systems	P. 009
Bicycle helmet and clothing	P. 009
Replacement of defective or bent parts	P. 010
Maintenance and care	P. 011
Checklist	P. 012
Tightening torques for Scott Bikes	P. 014
Bicycle care	P. 015
Spare parts	P. 015
Warranty	P. 016
SCOTT Service Plan	P. 018



CONGRATULATIONS

Congratulations on your purchase of a new Scott bicycle! We are confident that the bicycle will exceed your expectations for value, performance, and ride quality. Each frame set and component has been custom specified and designed to enhance your riding experience. Whether you are a beginning cyclist, or a seasoned pro, Scott bicycles will provide endless hours of two-wheeled fun.

We strongly encourage you to take the time to read this manual and familiarise yourself with your new bicycle. If you have purchased a bike for your children, please take the time to make sure they understand the information contained in this Owner's Manual.

Important!

If you purchased this bicycle for a minor, it is essential that a responsible adult/parent thoroughly reviews and reads the Owner's Manual to the minor.

Please make sure to get your Scott bike completely assembled from your authorized Scott dealer.

This is very important for optimum performance and safety and guarantees you a long lasting joy while riding your bike.

It is important to understand the basics of riding a bicycle, but it is equally important to exercise common sense when cycling. Cycling is a dynamic sport and requires reacting to varying situations. Like any sports, cycling involves risk of injury and damage. By choosing to ride a bicycle, you assume the responsibility for that risk.

Important!

Please use the bike of your choice only for the purpose it was made for.

For instance a road racing bike can not be used to substitute a mountain bike in off road terrain or a Trekking bike can not be used for downhill racing or road racing.

If you have questions or problems regarding your new Scott bicycle, please contact your Authorised Dealer.

Ride Frequently!

GENERAL INTRODUCTION

Legal advice:

Your new Kids bike meets, (as complete equipped model), all demands of the traffic law standards and is allowed to be used in public streets.

It is obligatory that your child has reached the age of 8 years otherwise he/she should use the sidewalk, which is legal up to 10 years of age. Please check your national laws regarding this point!

Use of the bikes:

Maximum load of the bike must not exceed 50 kg.

The carrier (when supplied with the bike) is made for a maximum load of 20 kg. In general we recommend not to use the carrier on kids bikes for load transports due to the reduced riding performance. SCOTT kids bikes are built to be very robust, jumps or riding on stairways however exceed normal use.

SAFETY

When producing your SCOTT kids bike we only spec'd parts of high quality and which offer safety under all riding situations. This is very important when participating in public traffic. You will reach a maximum of safety by avoiding any dangerous situations.

- Make sure that your child is well experienced in cycling when riding in public traffic. Please be reminded that your child needs some time to get used to his/her new bike. In addition children are allowed to ride on the sidewalk up to an age of 10 years.
- To react in the right way on public streets it is important for your child to know about the traffic laws.
- Do not stress your child. It might happen that other participants in traffic, especially cars, will make feel him/her unsure. Please have some lessons on how to ride in a parking ground before participating in traffic.

ASSEMBLY OF TRAINING WHEELS

Assembly of training wheels (only 12" and 16" models) and adjustment of chain tension on bikes without rear derailleurs. For the assembly of the optional training wheels for 12" and 16" bikes please follow the instruction below:

- Release on one side of the rear wheel nut A and remove it including the washer.
- Put part B in part C and fix it with nut A with the washer between nut A and part C
- Assemble now the bolt and nuts/washers as shown below to fix the wheel on part B
- The long sleeved hole D will help you to balance the bike when you assembled on the other side of the bike the parts as mentioned above.
- Both training wheels should be with a distance of 1-1.5cm to the ground when the bike is balanced on its wheels. After balancing the bike please tighten the wheel fixing nuts and the counter nuts.

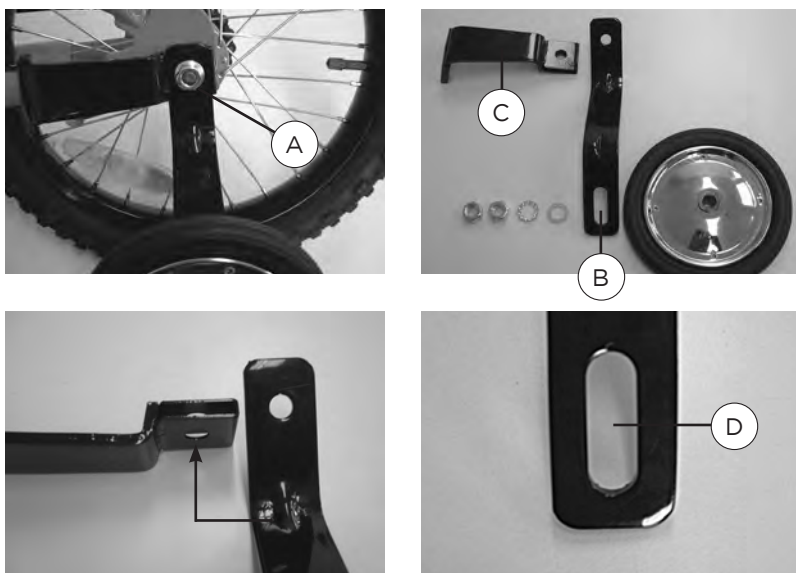

CHAIN TENSION

In case the chain needs to be tensioned again, please release on both sides nut A and pull the rear wheel straight backward until the tension is ok.

Please retighten nut A on both sides. Please note the tightening torque as mentioned in the table of tightening torques at the end of this file.

BRAKES

- Your new bike is equipped with two brakes which work independently of each other.
- In case you can pull the brakelever more than half of its way to the handlebar, you should readjust the brake.

To do so, please follow as shown below:

V-Brake

1. While holding the shoe against the rim, tighten the shoe fixing nut.
2. Pass the inner cable through the inner cable lead, and after setting so that the total of the clearances between the left and right shoes and the rim is 2 mm tighten the cable fixing bolt.

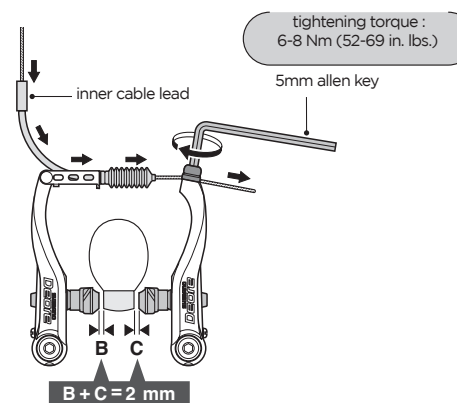

3. Adjust the distance with the spring tension adjustment screws.

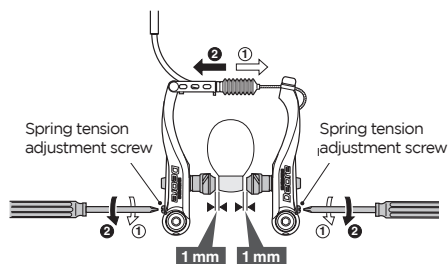

4. Depress lever about 10 times

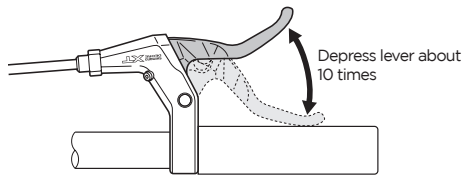

Caliper brake

Release counter nut A and turn adjustment screw B counter clockwise until the distance between brake pads and rims is approx. 2mm on each side. Tighten counter nut A.

- In case adjustment screw B is released already to the limit, please release cable clamping screw C and turn adjustment screw clockwise to its original position.
- Close the caliper brake with your hand to the rim, adjust the brake cable and tighten clamping screw C. Please note the table of tightening torques at the end of this file.
- Finally make the fine tuning with adjustment screw B as mentioned above. The wheel needs to spin free without touching the brake pads. Fix counter nut A.



Important:

Make sure that the brake works perfectly.

Important:

Under wet conditions the brake performance can decrease which will result in a prolongation of the braking distance.

LIGHT SYSTEMS

- light the front and rear lights by the beginning of the dusk. To switch on the dynamo press with the thumb on the button. But never while riding! To check the function of front and rear light turn the raised front wheel.
- Under wet conditions the effectiveness of the dynamo may decrease.

BICYCLE HELMET AND CLOTHING

- Please take care that your child wears clothing with bright colors and, if possible, with reflective stripes or fabrics.
- A helmet that fits is the best way to avoid head injuries. The helmet should meet DIN EN 1078 and should have the CE label. By choosing bright colors it will help to improve the visibility. Wearing such a helmet should be matter of course for all cyclists. In addition consider to be a good example for children.

REPLACEMENT OF DEFECTIVE OR BENT PARTS

In case the bike is damaged by a crash or accident, please replace all damaged parts immediately at your local SCOTT dealer. Never try to repair bent parts, they might fail and cause an accident!

Before riding:

In the beginning the seat height should be adjusted in that way that your child, when sitting on the saddle, can reach the ground with both feet. When more experienced the saddle can be raised up into perfect riding position.

Important

Never exceed the seatpost and stem over the marked area. Otherwise the connection can get loosen and can cause in worst case a crash.

Please check that your child can reach easily the handlebar and use brake- and shifting levers as well as the bell.

Before every ride:

The traffic laws demand that one checks all functions that concern safety. Check every brake when starting to ride. Also check the function of front and rear light and check the air pressure of the tyres.

MAINTENANCE AND CARE

In addition to the checks listed above please check your bike regularly or if necessary, according to the following list or contact your local SCOTT dealer to do so in order to reach maximum safety and fun while riding.

- All bolts and nuts, especially the quick releases of the wheels for proper fit and in case they are loose tighten them .
- Stem and handlebar for visible damages and replace them if necessary. Please make sure that the bolts are tightened evenly when closing the front cap, according to the tightening torque recommended by the producer of the parts.
- Braking systems
- Air pressure of the tyres according to the recommendation of the producer.
- Light systems and bell
- Handlebar grips to be fixed to the handlebar
- All parts of the rear suspension system including mounting bolts
- The front suspension fork for perfect function and play in the bushings.
- Front and rear derailleur for perfect function and grease them. If necessary readjust the system and clean it.
- The play of the headset. If necessary readjust it.
- Brake and shifting cables for perfect wear and leakage on hydraulic systems. If necessary grease the cables.

The table of maintenance below may help you to check your bike regularly and keep the full performance of your bike.



CHECKLIST

Part	Description	OK
Saddle/seatpost	<ul style="list-style-type: none"> - Saddle tightened on seatpost - Seatpost tightened in frame - Check for minimum insertion line (min.55mm!) 	
Bar/stem	<ul style="list-style-type: none"> - Check for minimum insertion (min. 65mm!) - Stem tightened on fork steerer - Bar tightened on stem - Easy to reach 	
Brake	<ul style="list-style-type: none"> - Brake levers easy to reach - Function ok - Check wear of brake pads - Check position of the brake pads on the rim - Brake surface on rim without oil or grease 	
Coaster brake	<ul style="list-style-type: none"> - Function ok 	
Shifting parts	<ul style="list-style-type: none"> - Function ok, adjusted acc. to owner's manual 	
Chain	<ul style="list-style-type: none"> - Chain tension ok - Chain lubricated - Chaincase in good condition (if existing) 	
Tires	<ul style="list-style-type: none"> - Profile ok - Check air pressure acc. to recommendation shown on sidewall 	
Wheels	<ul style="list-style-type: none"> - Spoke tension ok and equalized - Axle nuts/quick release tightened 	
Training wheels	<ul style="list-style-type: none"> - Check fixation screws 	
Pedals	<ul style="list-style-type: none"> - Antislip surface - Tight fixed on cranks - Bearings without lose play 	
Bell	<ul style="list-style-type: none"> - Easy to reach 	
Front light	<ul style="list-style-type: none"> - Tight fixed and adjusted - Bulp ok - Reflector clean and without cracks 	
Dynamo	<ul style="list-style-type: none"> - Easy rolling on tire - Electrical connections ok - Light system checked 	

Part	Description	OK
Tail light	<ul style="list-style-type: none"> - Tight fixed and adjusted - Bulp ok - Reflector clean and without cracks 	
Reflectors	<ul style="list-style-type: none"> - Tight fixed and adjusted - Clean and without cracks 	
Visual check	<ul style="list-style-type: none"> - All parts without visible defects, all screws tightened acc. to table of tightening torques 	
Screws	<ul style="list-style-type: none"> - all screws tightened acc. to table of tightening torques 	

In case you are not 100% sure that you can do the check properly please contact your dealer to avoid damages, crashes or injuries.



TIGHTENING TORQUES FOR SCOTT BIKES

Rear Derailleur	Mounting bolt	7.8-9.8 Nm
	Cable fixing bolt	3.9-5.9 Nm
	Pulley screws	2.9-3.9 Nm
Front Derailleur	Clamp	4.9-6.8 Nm
	Cable fixing bolt	4.9-6.8 Nm
Rapidfire lever	Clamp mounting bolt	4.9-6.8 Nm
STI	Clamp mounting bolt	4.9-6.8 Nm
Brake lever	Clamp mounting bolt	4.9-6.8 Nm
Freewheel hub	Freewheel body	35-49 Nm
	Cassette fixing nut	30-49 Nm
Crankset	Square type	35-45 Nm
	Spline type	35-50 Nm
	Chainring screws	7.8-10.7 Nm
BB-Cartridge		50-70 Nm
Pedals		40 Nm
Stem	Mounting bolts M5	5.6-7.8 Nm
	M6	9.8-13.7 Nm
Seatpost-seatclamp	M4	2.8-3.9 Nm
	M5	5.6-7.8 Nm
	M6	9.8-13.7 Nm
V-Brake	Frame mounting bolts	5-6.8 Nm
	Cable fixing bolt	5.8-7.8 Nm
	Brake pad bolts	5-6.8 Nm
Caliper Disc brake	Magura	6 Nm
	Shimano	6-8 Nm
	Formula	9 Nm
	Hayes	12 Nm
Disc mounting bolts	Magura	4 Nm
	Shimano	2-4 Nm
	Formula	6.2 Nm
	Hayes	5 Nm

BICYCLE CARE

In order to keep the function and optic of the bike in good condition we recommend periodical bicycle care.

Doing so keeps the value of the bike and helps to prevent from corrosion or other damages:

- clean with soft brush, water and soft towel. Do not use high pressure cleaner, otherwise bearings, color or decals can be damaged.
- Do not use aggressive cleaning additives
- Repair color damages at once
- Grease or oil all metal parts especially during winter use

Please use biodegradable bicycle cleaners and degreasers which are offered at your local dealer.

SPARE PARTS FOR YOUR SCOTT BIKE

For buying spare parts we strongly recommend to visit your local Scott dealer as he knows best which parts will fit to your bike and can help you to make your choice of parts matching to your bike.

By doing so, you can avoid a combination of parts that might not match to each other. Please only use original spare parts as only these can guarantee optimum function and safety while riding.

This is extremely important on parts of the brake system, the tire and air tube.

Never use adapter solutions to fix or assemble brakes, seat/seatpost and stem/handle bar!

WARRANTY

SCOTT bikes are made using the most innovative production and quality methods. They are equipped with best components of well known parts suppliers.

Doing so SCOTT warrants its frames and swingarms for five years (subject to compliance with maintenance ranges, see below) and SCOTT forks (provided it is a fork of SCOTT) for two years for defects in material and/or workmanship in case of purchase of completely assembled bikes.

This warranty of 5 years for the frames shall only be granted in case once a year a maintenance service has been effected according to maintenance requirements as set forth in this manual by an authorised SCOTT dealer.

The authorised SCOTT dealer shall confirm the effected annual maintenance service by stamp and signature.

In case such an annual maintenance service has not been effected the warranty of 5 years for the frame shall be reduced to 3 years.

Costs for maintenance and service have to be born by the owner of the SCOTT bike.

On Gambler, Voltage Fr and Volt-X the warranty period is limited to 2 years.

The warranty period starts at the day of purchase. This warranty is limited to the first buyer, what means the first person who uses the bike and only with the use it was made for. Furthermore, this warranty is limited to purchases via authorized SCOTT-dealers

The warranty is solely granted in case of purchase of a completely assembled bike to the explicit exclusion of purchases of not completely assembled bikes.

In case of a warranty claim the decision to repair or to replace the defective part is up to SCOTT. Non defective parts will only be replaced at the guarantee's own expense.

Fair wear and tear is not covered by the warranty.

A complete list of all parts of wear and tear can be found in the next chapter of this manual.

In addition, you will find at the end of this manual a protocol for the handing over of the bike which will remain in copy at the SCOTT dealer after acceptance and signature of the consumer.

It is obligatory to show this protocol of handing over together with the defective part in case of a warranty claim given that it provides evidence of purchase. Otherwise no warranty is granted.

In principle, this warranty is granted worldwide. Claims must be made through an authorized dealer, for information regarding the nearest dealer, write or call this company or the national SCOTT distributor.

Normal wear, accident, neglect, abuse, improper assembly, improper maintenance by other than an authorized dealer or use of parts or devices not consistent with the use originally intended for the bicycle as sold are not covered by this warranty.

Hereby SCOTT grants a voluntarily manufacturer's warranty. Additional entitlements according to national warrant of merchantability are reserved.

WARRANTY

SCOTT Bike Warranty Periods

	Year 1	Year 2	Year 3	Year 4	Year 5
SCOTT Bikes					
Gambler, Voltage FR, Volt-X					

Regular Warranty Period

Option for prolongation according to maintenance intervals shown in manuals attached to bikes



SCOTT SERVICE PLAN

Model

Year

Size

Frame

Date of purchase

Annual service to be done

- Check of shock mounts incl. lubricating the bushings
- Check of swingarm pivot incl. axle and mounts
- Check of rear shock according to the enclosed shock manual
- Check of hubs, bottom bracket and headset
- Check of all screws of the bike
- Check of handle bar, stem, saddle rails and seat post
- Check if brakepads and rims are worn out
- Check of disc brake according to enclosed service manual
- Check of suspension fork according to enclosed service manual
- Check of shifters and derailleurs incl. cables.

Date of Service:

Dealers Signature:

SCOTT SERVICE PLAN

Model

Year

Size

Frame

Date of purchase

Annual service to be done

- Check of shock mounts incl. lubricating the bushings
- Check of swingarm pivot incl. axle and mounts
- Check of rear shock according to the enclosed shock manual
- Check of hubs, bottom bracket and headset
- Check of all screws of the bike
- Check of handle bar, stem, saddle rails and seat post
- Check if brakepads and rims are worn out
- Check of disc brake according to enclosed service manual
- Check of suspension fork according to enclosed service manual
- Check of shifters and derailleurs incl. cables.

Date of Service:

Dealers Signature:

KIDS



KIDS



ENGLISH

SCOTT SERVICE PLAN

Model

Year

Size

Frame

Date of purchase

Annual service to be done

- Check of shock mounts incl. lubricating the bushings
- Check of swingarm pivot incl. axle and mounts
- Check of rear shock according to the enclosed shock manual
- Check of hubs, bottom bracket and headset
- Check of all screws of the bike
- Check of handle bar, stem, saddle rails and seat post
- Check if brakepads and rims are worn out
- Check of disc brake according to enclosed service manual
- Check of suspension fork according to enclosed service manual
- Check of shifters and derailleurs incl. cables.

Date of Service:

Dealers Signature:

SCOTT SERVICE PLAN

Model

Year

Size

Frame

Date of purchase

Annual service to be done

- Check of shock mounts incl. lubricating the bushings
- Check of swingarm pivot incl. axle and mounts
- Check of rear shock according to the enclosed shock manual
- Check of hubs, bottom bracket and headset
- Check of all screws of the bike
- Check of handle bar, stem, saddle rails and seat post
- Check if brakepads and rims are worn out
- Check of disc brake according to enclosed service manual
- Check of suspension fork according to enclosed service manual
- Check of shifters and derailleurs incl. cables.

Date of Service:

Dealers Signature:

KIDS



KIDS



ENGLISH

SCOTT SERVICE PLAN

Model

Year

Size

Frame

Date of purchase

Annual service to be done

- Check of shock mounts incl. lubricating the bushings
- Check of swingarm pivot incl. axle and mounts
- Check of rear shock according to the enclosed shock manual
- Check of hubs, bottom bracket and headset
- Check of all screws of the bike
- Check of handle bar, stem, saddle rails and seat post
- Check if brakepads and rims are worn out
- Check of disc brake according to enclosed service manual
- Check of suspension fork according to enclosed service manual
- Check of shifters and derailleurs incl. cables.

Date of Service:

Dealers Signature:

